

Robert Martin

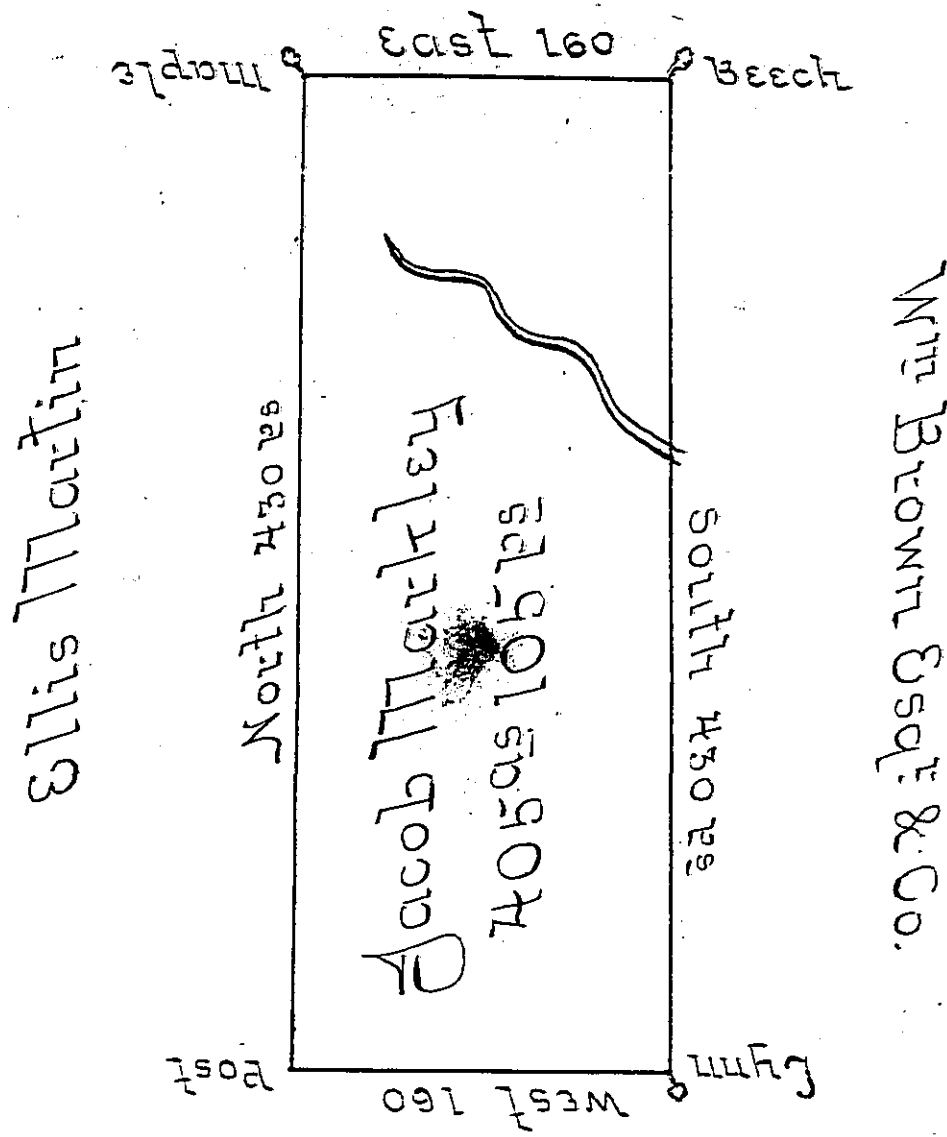

Thomas Martin

Situated on the Waters of Crooked Creek a Branch of
 Black Lick Creek in Wheatfield Township Westmore-
 land County containing 405 Acres & 105 p^e and Allow-
 ance for Roads &c Surveyed for Jacob Markley the 5th
 day of Dec^r 1794 on Warrant Dated 5th Day of May
 1795

James Ross D.S.

Daniel Broadhead Esq D.S.

IN TESTIMONY that the above is a copy of the original remaining on file in
 the Department of Internal Affairs of Pennsylvania, made
 conformably to an Act of Assembly approved the 16th day of
 February, 1833, I have hereunto set my Hand and caused
 the Seal of said Department to be affixed at Harrisburg,
 this fourth day of March 1902.

James W. Fatta
 Secretary of Internal Affairs.